

Technical Specifications

Pre-Glued Veneer Edgebanding

1. Product name:

Pre-Glued Veneer Edgebanding

2. Producer

TECE Dekor A.S.
Bursa Org. San. Bölgesi 75. Yil Bulvari No:12
Nilüfer/Bursa/ Turkey
Tel: +90 224 242 2100(pbx)
Fax: +90 224 243 8525

3. Description

Veneer edgebanding is made from slices of real wood; therefore, it works like real wood (it can be painted, varnished to match the other parts of wood furniture). Veneer edgebanding is produced by joining individual pieces of veneer together into a continuous roll with invisible finger-joints. The veneer sheets are color and design matched at the points of transition from one sheet to another. Pre-glued veneer edgebanding is essentially used in straight edges. See below for its common usage:

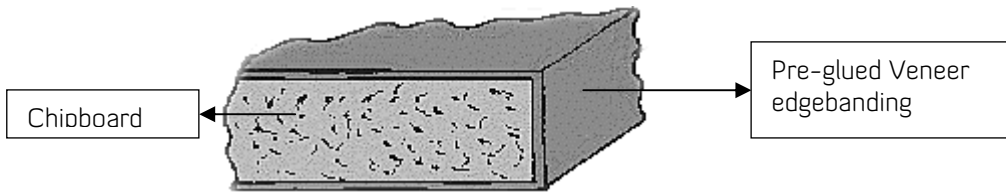

To give a wood finishing look to the furniture, veneer edges make it easy for the users to compile the furniture. With hot melt backed veneer edgebanding, the product can be applied with iron or hot air blower.

4.Specifications:

Species: It is real wood; therefore, it is unavoidable to get color change at each order. Species of Oak, Beech, Pine,

Mahogany, Ash, Cherry, and Walnut are usually kept in stock. Artificial and other species might be available upon request.

Surface: Pre-glued veneer edgbanding is pre-sanded and therefore ready for final finishing.

Hotmelt: EVA based hotmelt is used on the back side of the product. Approximately 300 gr of hotmelt is applied to one square meter of edgbanding. When applying the edgbanding with an iron, the temperature should be about 160 c° - 170 c°. Users should make sure that the hotmelt is actually melted on the board surface.

5. Available Sizes

The width of the veneer edge banding can change based on the customer demand (such as 18mm, 22mm, 38mm or etc). The thickness of edgbanding is 0.55 mm \pm 0.05mm (without the hotmelt glue).

The length of standard rolls is 50mt. This can also change if the customer desires.

6. Application Instructions

Fleece-backed veneer edgbanding can be applied to the board with EVA based hotmelt in edgbanding machine.

7. Packaging

Each 5 rolls are shrink-wrapped with plastic nylon.

The standard box dimensions are 35cm x 35cm x 46cm.

8. Technical Services

In case you need any technical support, please contact TECE at

Tel: +90 224 242 2100

Fax: +90 224 243 8525

6. Application Instructions

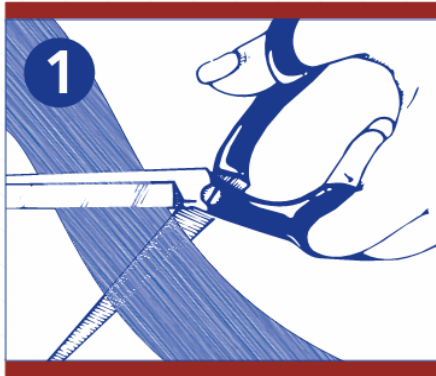

1. Cut the edgebanding 3 cm longer than surface to be covered. Make sure the surface is dust-free, clean, and dry. Also check to see there are no rough spots on the surface.



2. Apply the edgebanding with hot iron or hot air blower as described. It is recommended to use paper to protect iron bottom.

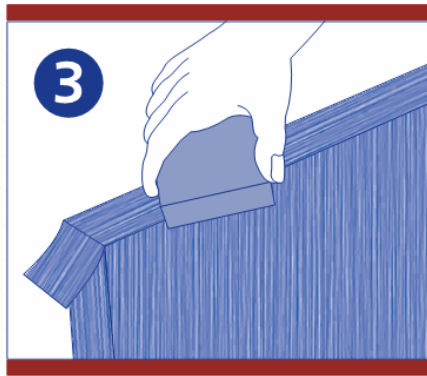

3. While still hot, press firmly with a wood block to the board.

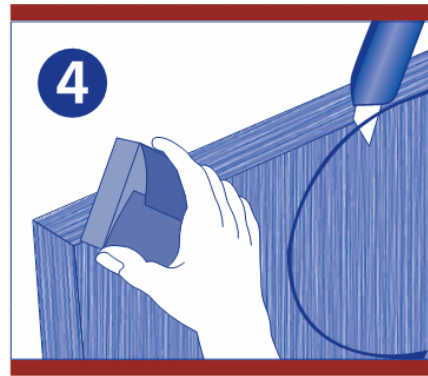

4. Allow the edgebanding to cool completely, remove the extra edges with a trimmer or a cutting blade and sand the edges.

This edgebanding can be applied to the board with a hot iron or hot air blower. A minimum temperature of 150° - 175° is required to get a correct bonding effect. For an electrical iron, adjust the temperature to wool/silk/cotton range; and make sure that you hold the iron for 10-15 seconds. If the iron is held too long or the temperature in the iron is too

high, you will evaporate the hotmelt and the product will not stick to the board. As for hot air blower, adjust the temperature to 170° - 190°.

If you apply edgebanding as described, it will keep its integrity up to temperature of 60°-65°. Following the instructions will result in the best edgebanding experience.

8. Packaging

All veneer edgebanding is re-inspected several times by the quality control department before it is sent. It is always packed with plastic packing to ensure a better self time. The rolls comes in boxes with dimensions of 32.5cm*32.5cm*47cm.